



## INOGEN ONE G5 PRODUCT OVERVIEW

SALES

oxygen. anytime. anywhere.®

Proprietary and Confidential  
Inogen Internal Use Only

# Inogen One G5 Specifications



<b>Dimensions:</b>	L / W / H: 7.19 in. / 3.26 in. / 7.11 in.
w/ 8-cell battery	L / W / H: 7.19 in. / 3.26 in. / 8.15 in.
w/ 16-cell battery	L / W / H: 7.19 in. / 3.26 in. / 9.03 in.
<b>Weight:</b>	<b>4.7 pounds (includes single battery)</b>
<b>Noise:</b>	<b>38 dBA at setting 2</b> Maximum Sound Power of 60 dBA and Maximum Sound Pressure level of 50 dBA per ISO 80601-2-69
<b>Warm up time:</b>	<b>2 minutes</b>
<b>Oxygen Concentration**:</b>	<b>90% - 3% /+ 6% at all settings</b>
<b>Flow Control Settings:</b>	<b>6 settings: 1 to 6</b>
<b>Maximum Outlet Pressure</b>	<b>&lt; 28.9 PSI</b>
<b>Power: AC Power Supply:</b>	<b>AC Input: 100 to 240 VAC</b> <b>50 to 60 Hz</b> <b>Auto-Sensing: 2.0-1.0A</b>
<b>DC Power Cable:</b>	<b>DC Input: 13.5-15.0VDC</b>
<b>Rechargeable Battery:</b>	<b>Voltage: 12.0 to 16.8 VDC (±0.5V)</b>
<b>Battery Duration*:</b>	<b>Up to 6.5 hours with single battery</b> <b>Up to 13 hours with double battery</b>
<b>Battery Charging Time:</b>	<b>Up to 3 hours for a single battery</b> <b>Up to 6 hours for a double battery</b>
<b>Environmental Ranges Intended for Use:</b>	<b>Temperature: 41 to 104°F (5 to 40°C)</b> <b>Humidity: 0% to 95%, non-condensing</b> <b>Altitude: 0 to 10,000 ft (0 to 3048 meters)</b>
<b>Environmental Ranges Intended for Shipping and Storage:</b>	<b>Temperature: -13 to 158°F (-25 to 70°C)</b> <b>Humidity: 0% to 95%, non-condensing</b> <b>Store in a dry environment</b> <b>Altitude: 0 to 10,000 ft (0 to 3048 meters)</b>

\*Battery time varies with flow setting and environmental conditions

\*\* Based on atmospheric pressure of 14.7 psi (101 kPa) at 70°F (21°C)

oxygen. anytime. anywhere.®

Proprietary and Confidential  
Inogen Internal Use Only

# Bluetooth App Compatibility



oxygen. anytime. anywhere.®

Proprietary and Confidential  
Inogen Internal Use Only

# G5 System Weight and Dimensions



Configuration	Alone		With Bag	
	Kg	Lbs	Kg	Lbs
Concentrator	1.61	3.55	1.95	4.30
Concentrator w/ 8-cell	2.15	4.74	2.49	5.48
Concentrator w/ 16-cell	2.60	5.73	2.93	6.47
8-cell battery	0.54	1.19	n/a	n/a
16-cell battery	0.99	2.18	n/a	n/a
Bag	0.34	0.74	n/a	n/a
Power Supply (with cord)	0.59	1.31	n/a	n/a

	Length		Width		Height	
	Cm	In	Cm	In	Cm	In
Concentrator	18.26	7.19	8.31	3.26	18.06	7.11
w/ 8-cell battery	18.26	7.19	8.31	3.26	20.70	8.15
w/ 16-cell battery	18.26	7.19	8.31	3.26	22.94	9.03



# G5 Pulse Volumes at Flow Settings



Same as G3 and G4 but with one more setting

G5 Flow Setting						
Breaths per Minute	1	2	3	4	5	6
15	14	28	42	56	70	84
20	11	21	32	42	53	63
25	8	17	25	34	42	50
30	7	14	21	28	35	42
35	6	12	18	24	30	36
40	5	11	16	21	26	32

mL/breath +/- 15% per ISO 80601-2-67

Total Volume per Minute (ml/min)	210	420	630	840	1050	1260
-------------------------------------	-----	-----	-----	-----	------	------

# G5 User Interface Panel

- **New Larger Display Screen**
- **Displays Symbols and Numbers Only**
- **No Text**

(refer to user manual for all symbol definitions)

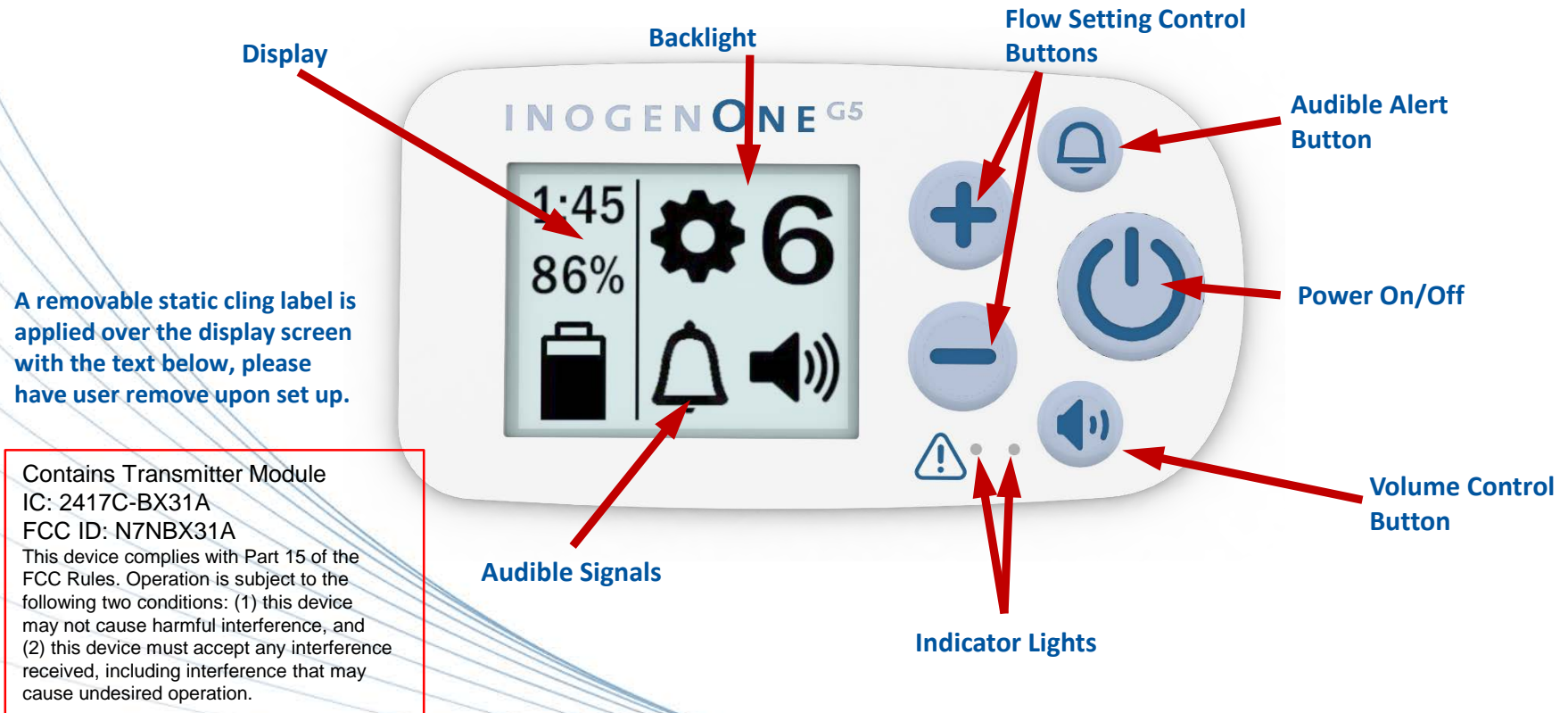

# G5 Power Supplies

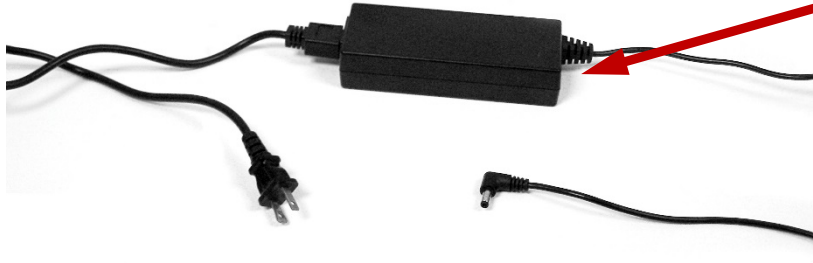

## BA-501 AC Power Supply

Input: 100 to 240 VAC, 50 to 60 Hz  
Auto-sensing: 2.0-1.0A for worldwide use



## BA-306 DC Power Cable

Input: 13.5-15.0 VDC

oxygen. anytime. anywhere.®

Proprietary and Confidential  
Inogen Internal Use Only

# G5 Power Port

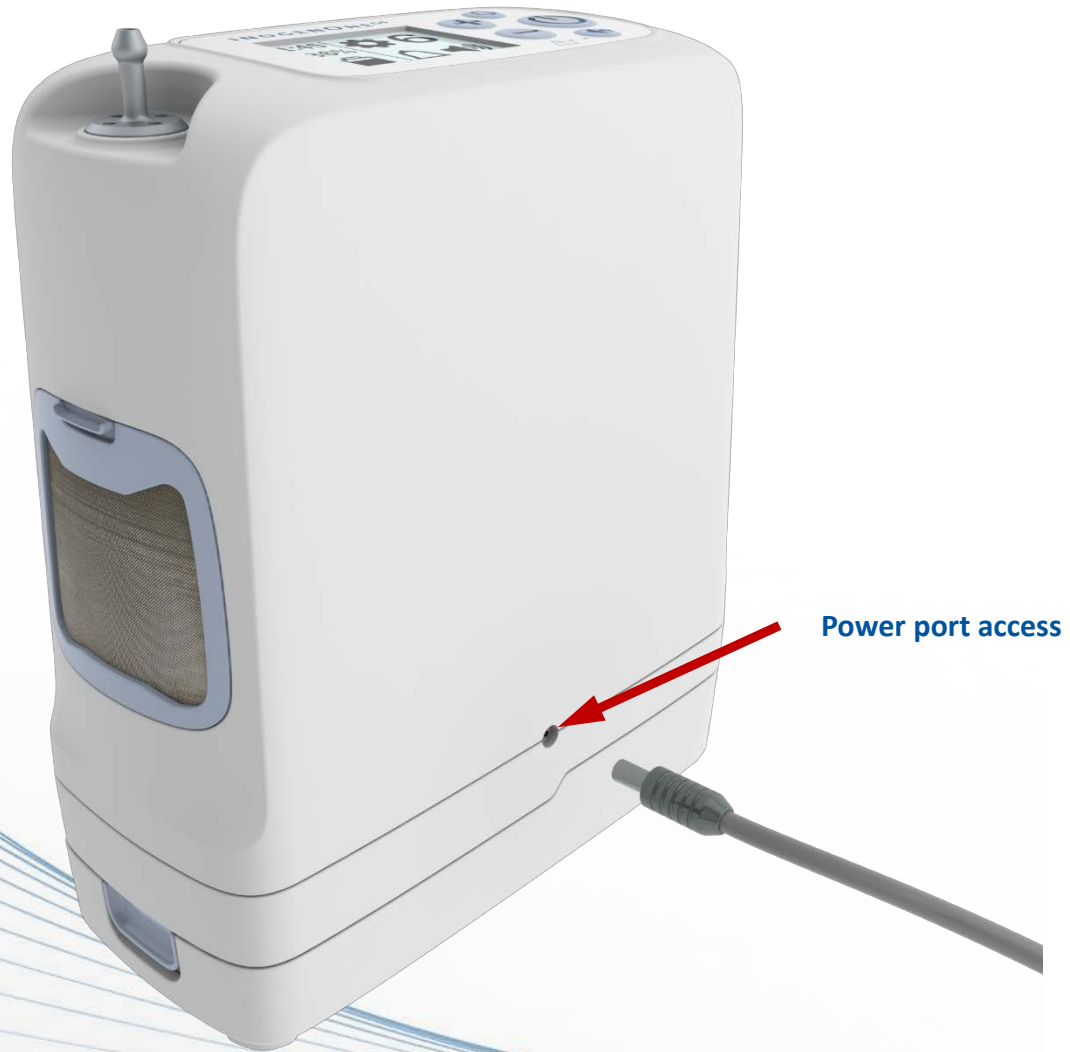

oxygen. anytime. anywhere.®

Proprietary and Confidential  
Inogen Internal Use Only



# G5 Battery Location



Slide battery on



Latch will click into place when the battery is in position

oxygen. anytime. anywhere.®

Proprietary and Confidential  
Inogen Internal Use Only

# G5 Battery Options



Model # BA-500  
8 Cell Battery  
~ 6.5 Hours Run Time



Model # BA-516  
16 Cell Battery  
~ 13 Hours Run Time



Battery Indicator Gauge

oxygen. anytime. anywhere.®

Proprietary and Confidential  
Inogen Internal Use Only

# G5 Battery Run Times



	Power Consumption (W)	8-cell run time (hours:minutes)	Power Consumption (W)	16-cell run time (hours:minutes)
Setting 1.0	14.6	6:35	14.8	13:28
Setting 2.0	18.7	5:03	18.4	10:22
Setting 3.0	26.9	3:27	26.7	7:01
Setting 4.0	37.8	2:25	37.4	4:55
Setting 5.0	48.5	1:51	48.4	3:48
Setting 6.0	61.5	1:26	61.1	2:58

# G5 Battery Charge Times



	8-cell charge time (hours:minutes)	16-cell charge time (hours:minutes)
Standby	2:46	3:48
Setting 1.0	2:49	3:53
Setting 2.0	2:47	3:53
Setting 3.0	2:46	3:50
Setting 4.0	2:45	3:49
Setting 5.0	2:43	4:43
Setting 6.0	3:09	5:40



# Air Intake and Exhaust Locations



**Intake Vents**  
Gross Particle Filters should be removed  
and cleaned weekly – #RP-500

**Exhaust Vent**

oxygen. anytime. anywhere.®

Proprietary and Confidential  
Inogen Internal Use Only

# G5 Columns # RP-502



Remove Dust  
Caps before  
installing



Remove Dust  
Caps before  
installing

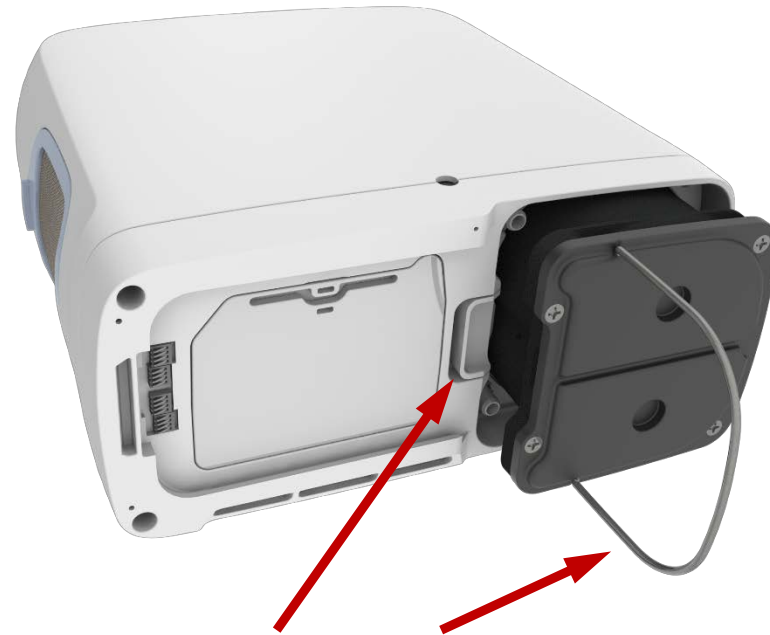

Access columns by removing battery and  
sliding latch, open wire ring and pull columns  
out.

oxygen. anytime. anywhere.®

Proprietary and Confidential  
Inogen Internal Use Only

# Inogen One G5 Carry Bag Model # CA-500



G5 intake and exhaust vents should be visible through mesh, on front, sides and bottom of bag



Exhaust Vent



Intake Vent



Intake Vent



Padded footing is designed for use with both single and double battery. Bottom mesh is intended to allow air flow for exhaust and battery.



# Inogen One G5 Carry Bag Model # CA-500 continued



Cut angle in top of bag for proper orientation of device to access cannula port



Velcro top flap to access display



Small pocket with zipper closure under front flap

Small front pouch for extra cannula tubing

Pouch for inserting onto luggage handle or cart



Grab Handle

Cut out for power port access

Perforated material at back of bag to allow for air flow to device and battery

oxygen. anytime. anywhere.®

Proprietary and Confidential  
Inogen Internal Use Only



# Inogen One G5 Carry Bag Model # CA-500, Carry Strap Details



Carry strap is adjustable from 28" to 53"  
Includes a removable shoulder pad and  
swivel fasteners



Removable shoulder pad

Swivel fasteners



# Optional Accessory G5 Backpack Model # CA-550



oxygen. anytime. anywhere.®

Proprietary and Confidential  
Inogen Internal Use Only

# G5 Backpack continued



Inside view;  
two back  
mesh pockets,  
large inside  
pocket and  
small hook for  
keys



Adjustable and  
removable chest  
strap 7" to 16"



Padded for  
comfort

Buckles for adjusting  
straps 26" to 58"

oxygen. anytime. anywhere.®

Proprietary and Confidential  
Inogen Internal Use Only



# Optional Accessory External Battery Charger Model # BA-503



When the battery is in the correct position, a solid red light will indicate that the battery is charging.

When the green light illuminates, the battery is fully charged.

oxygen. anytime. anywhere.®

Proprietary and Confidential  
Inogen Internal Use Only







## Inogen One G5 System Includes:

- Inogen One G5 Concentrator
- One Single Battery\*
- (1) Nasal Cannula (7ft. Soft style)
- Carry Bag
- AC Power Supply w/cable
- DC Power Cable
- User Manual
- Getting Started Guide
- Getting Started Guide Bluetooth App
- Warranty Statement (Invoice will state the specific warranty period)

\*Varies based on package sold, refer to IS-500-XX for details.

# Inogen One G5 System Packaging



oxygen. anytime. anywhere.®

Proprietary and Confidential  
Inogen Internal Use Only

# Positioning of the G5 in the Market



	<b>Inogen One G5</b>	<b>Caire Freestyle Comfort</b>	<b>Philips Respironics SimplyGo Mini</b>	<b>ResMed Mobi</b>
Single/Internal Battery System Price	\$2,995	\$2,695	\$2,995	\$2,295
Settings	1-6 pulse	1-5 pulse	1-5 pulse	1-4 pulse
Weight w/single battery	4.7lbs	5lbs	5lbs	5.5lbs w/internal battery
Dimensions w/single battery	7.19" x 8.15" x 3.26"	10" x 7.3" x 3.1"	9.4" x 8.3" x 3.6"	7.95" x 9.6" x 4.49"
Sound at setting 2	38dBA	43dBA	42dBA	38dBA
Battery Duration at setting 2	Single Battery: Up to 5 hours Double Battery: Up to 10 hours	Single Battery: up to 4 hours Double Battery: up to 8 hours	Single Battery: up to 4.5 hours Double Battery: up to 9 hours	Internal Battery: 6 hours External Battery: 3 hours
DC Power Source (for automobile)	Cable only	Power supply w/cable	Power supply w/cable	Power supply w/cable
Max Output	1260 ml	1050 ml	1000 ml	680 ml
Output per Setting	210 ml	210 ml	200 ml	170 ml
Control Panel	Large LCD Display, Embossed/Backlit Power, Flow setting, volume control and mode Buttons, Indicator Lights, Symbol Based Display	Large Display Screen, Flow Setting and Power Buttons only	Touchscreen functionality, Symbol Based	Large LCD Display, Embossed Power, Flow setting and mode Buttons, Indicator Lights, Symbol and Alphanumeric Display
Removable Columns (Sieve Beds)	Yes	No	No	No
Max Cannula Length	25ft	7ft	10ft	7ft
FAA Clearance	Yes	Yes	Yes	Yes
Bluetooth Compatibility	Yes	Yes B2B only not DTC	No	No
Manufacture Warranty	3 year POC, 1 Year Columns & Accessories. Option for Lifetime	3 year POC, 1 Year columns, battery & power supply	3 year POC, 1 Year accessories	5 year POC, 1 Year columns, battery internal and external & accessories



## Talking Points



- Lighter than Inogen One G3.
- Quieter than Inogen One G3.
- Smaller than Inogen One G3.
- One more setting than Inogen One G3.
- Highest oxygen output per pound of any portable concentrator cleared for use in the U.S. homecare market.

oxygen. anytime. anywhere.®

Proprietary and Confidential  
Inogen Internal Use Only

# Component Maintenance and Replacement



Component	Maintenance	Replacement
<b>Filter Maintenance</b>		
Gross particle filter	Wash weekly	Not required within 5 year life
Intake filter	None	As needed indicated by alert prior to any performance degradation
Output filter	None	Replace as needed
Sieve bed maintenance	None	As indicated by alert prior to performance degradation
Compressor maintenance	None	As indicated by alert prior to any performance degradation
Valves	None	Not required within 5 year life
Oxygen sensor	None	Not required within 5 year life
Outer shell	Wipe down with damp cloth or mild detergent such as DAWN	Not required within 5 year life



THANK YOU!

oxygen. anytime. anywhere.®

Proprietary and Confidential  
Inogen Internal Use Only