

6 Quick Steps to Recharge Your Battery

Your Equipment Provider:

Your Physician:

INOGENONE® G5 External Battery Charger Guide



Inogen, Inc.
301 Coromar Drive,
Goleta, CA 93117
1-877-4-INOGEN (Toll Free)
1-877-446-6436 (Toll Free)
1-805-562-0515 (International)
info@inogen.net
www.inogen.com



INOGENONE® G5 External Battery Charger

Your Inogen One® G5 External Battery Charger (BA-503) will charge your Inogen One® G5 single and double batteries. It takes approximately 4.5 hours to charge a fully depleted single battery, and approximately 9 hours to charge a fully depleted double battery. Note: the battery will also recharge in the Inogen One® G5 when powered by the AC Power Supply, or DC Power Cable.

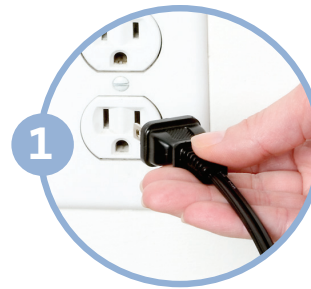

1 Plug the External Battery Charger AC power supply cord into an electrical outlet.



2 Plug the External Battery Charger AC power supply into the battery charger.



3 Slide the charger onto the Inogen One® G5 Battery by clicking and locking into the charger.



4 When the battery is in the correct position, a solid red light will indicate that the battery is charging.



5 When the green light illuminates, the battery is fully charged*.

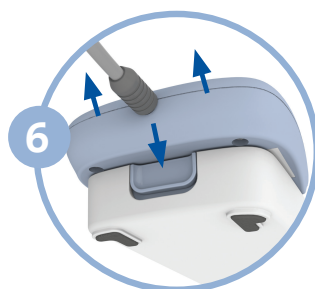

6 Press battery latch down and slide charger off battery.

inogen

©2021 Inogen. All rights reserved www.inogen.com

*If the red light is flashing, unplug the unit and complete steps 2-3 again. If a red flashing light continues after these steps, contact your Equipment Provider.